



Broadviews, Great Lumley, DH3 4HN
3 Bed - House - Mid Terrace
£150,000

ROBINSONS
SALES • LETTINGS • AUCTIONS • SURVEYS

Broadviews

Great Lumley, DH3 4HN

* RARELY AVAILABLE * BEAUTIFULLY PRESENTED AND MUCH IMPROVED * EXCELLENT LOCATION *

This beautifully presented and generously sized three-bedroom mid-terraced home on Broadviews is located on a sought-after pedestrianised, south-facing stretch of the street. With a modern and stylish interior throughout, this property is ideal for first-time buyers and growing families alike.

Nestled in the picturesque semi-rural village of Great Lumley, the property enjoys the tranquillity of green surroundings, quiet streets, and scenic walks, while remaining within easy reach of Chester-le-Street and beyond. Additionally, the home benefits from leased solar panels, helping to reduce gas and electricity costs.

The property features a stunning refitted kitchen and bathroom, enhancing its appeal. The open-plan kitchen/diner is fitted with sleek units and worktops, offering plenty of space for a dining table, while the rear lobby provides useful additional space, a utility area, and downstairs WC. The bright and airy living room, with its south-facing window, enjoys plenty of natural light and overlooks a pleasant green aspect.

Upstairs, the beautifully refitted bathroom complements three well-proportioned bedrooms, including two spacious doubles and a single, along with ample storage.

Outside, the property boasts a low-maintenance rear garden, and an enclosed front garden with artificial grass, making it a practical yet attractive outdoor space.

Combining contemporary living with the charm of a semi-rural location, this home is a fantastic opportunity.

Viewing is highly recommended!









GROUND FLOOR

Entrance Lobby

Lounge

15'5" x 11'9" (4.7 x 3.6)

Dining Kitchen

21'3" x 10'2" (6.5 x 3.1)

Rear Lobby

4'7" x 4'7" (1.4 x 1.4)

Additional Space / Versatile Room

6'10" x 6'2" (2.1 x 1.9)

Downstairs WC

Utility Room

8'6" x 5'6" (2.6 x 1.7)

FIRST FLOOR

Landing

Bedroom

13'9" x 10'5" (4.2 x 3.2)

Bedroom

12'5" x 9'10" (3.8 x 3)

Bedroom

8'6" x 6'10" (2.6 x 2.1)

Bathroom / WC

6'10" x 6'2" (2.1 x 1.9)

Agent's Notes

Electricity Supply: Mains / Leased Solar Panels

Water Supply: Mains

Sewerage: Mains

Heating: Gas Central Heating

Broadband: Basic 4 Mbps, Superfast 80 Mbps, Ultrafast 1,000 Mbps

Mobile Signal/Coverage: Average

Tenure: Freehold

Council Tax: Durham County Council, Band A - Approx. £1,621 p.a

Energy Rating: B



Disclaimer: The preceding details have been sourced from the seller and OnTheMarket.com. Verification and clarification of this information, along with any further details concerning Material Information parts A, B & C, should be sought from a legal representative or appropriate authorities. Robinsons cannot accept liability for any information provided.

Broadviews

Approximate Gross Internal Area
1098 sq ft - 102 sq m

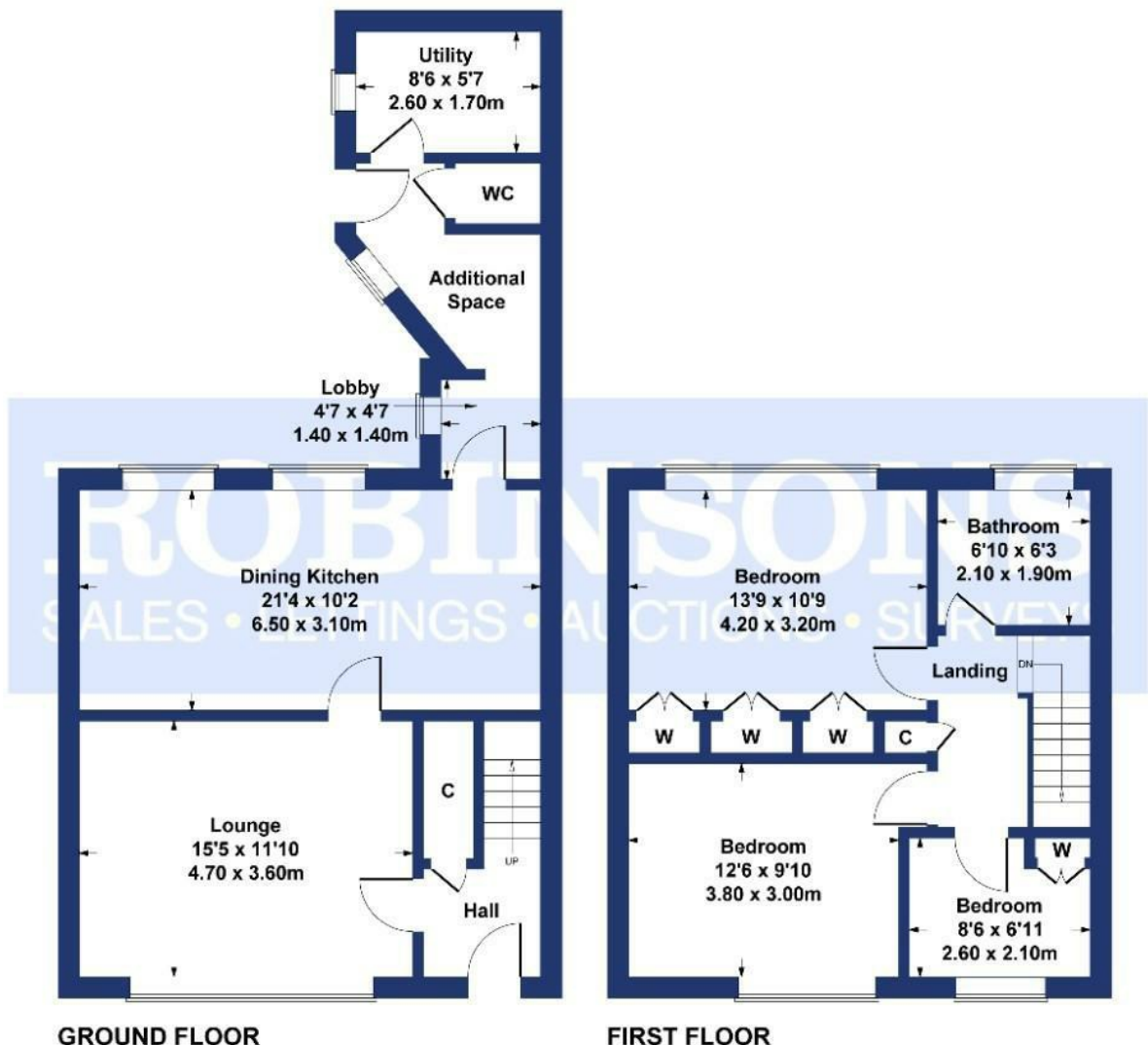

GROUND FLOOR

FIRST FLOOR

SKETCH PLAN FOR ILLUSTRATIVE PURPOSES ONLY

All measurements walls, doors, windows, fittings and appliances, their sizes and locations, are approximate only. They cannot be regarded as being a representation by the seller, nor their agent.

Produced by Potterplans Ltd. 2024

Energy Efficiency Rating		Current	Potential
Very energy efficient - lower running costs			
(92 plus) A			
(81-91) B			
(69-80) C			
(55-68) D			
(39-54) E			
(21-38) F			
(1-20) G			
Not energy efficient - higher running costs			
England & Wales		EU Directive 2002/91/EC	

89

81

For clarification we wish to inform prospective purchasers that we have prepared these sales particulars as a general guide. We have not carried out a detailed survey, nor tested the services, appliances and specific fittings. Room sizes should not be relied upon for carpets and furnishings, if there are important matters which are likely to affect your decision to buy, please contact us before viewing the property. Robnsons can recommend financial services, surveying and conveyancing services to sellers and buyers. Robnsons staff may benefit from referral incentives relating to these services.



45 Front Street, Chester Le Street, DH3 3BH
Tel: 0191 387 3000
info@robinsonscls.co.uk
www.robinsonsestateagents.co.uk

